

SITE PLAN OF THREE STORIED RESIDENTIAL BUILDING UNDER SEC. 393A OF K.M.C. ACT. 1980 COMPLYING B/R 2009 AT PREMISES NO. - 134, PATOARY PARA, WARD NO.- 104, BOROUGH NO.- XI, UNDER R.S. DAG NO. - 2385, R.S. KHATIAN NO.- 819, L.R. KHATIAN NOS.- 2848 & 2895, MOUZA- GARFA, J.L. NO.- 19, P.S.- SURVEY PARK.

SITE CO-ORDINATES IN WGS 84 AND SITE ELEVATION (AMSL) -			
REFERENCE POINTS MARKED IN SITE PLAN OF THE PROPOSAL.	CO-ORDINATES IN WGS 84		SITE ELEVATION (AMSL)
	LATITUDE	LONGITUDE	
(A)	22°29'51"N	88°23'32"E	8.00 M.
(B)	22°29'51"N	88°23'32"E	

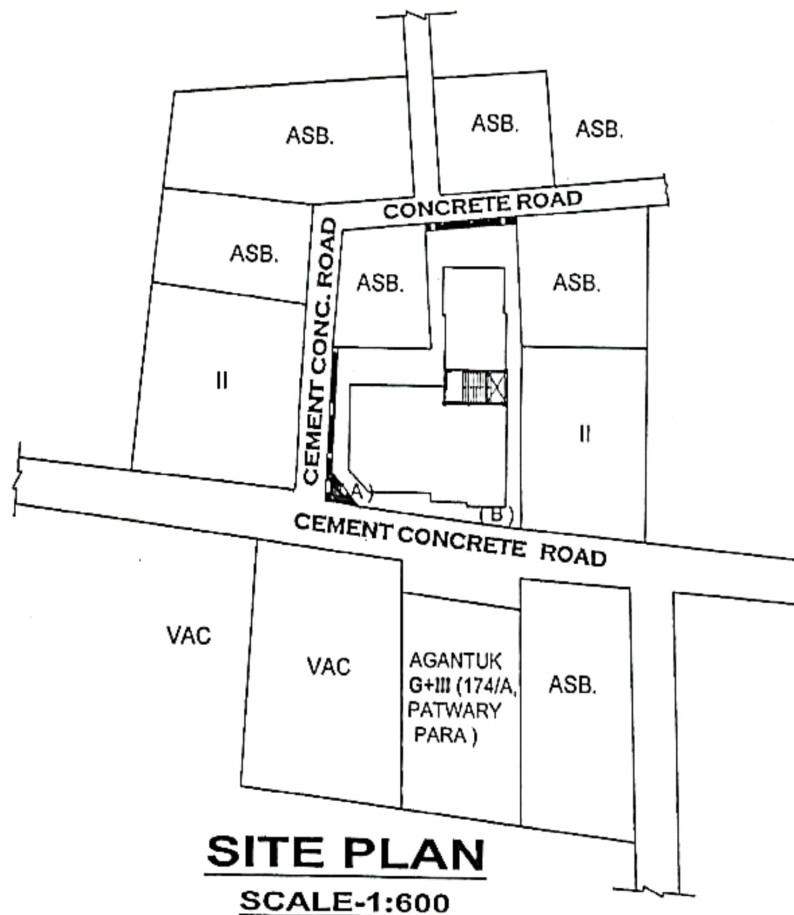

R. R. DEVELOPER  
*Rudip Kumar Nanda*  
 Proprietor

SIGNATURE OF DEVELOPER

*Hiranmoy Sarkar*  
 HIRANMOY SARKAR  
 L.B.S. (K.M.C.) CL-1 No.-1016

SIGNATURE OF L.B.S.